

# HINGE SERIES



## IMPRESSIONS OF TIMELESS FLAIR

Perfect motion for every single space

### Door Closing–Easy and Smooth



- The well-made Cervetti standard hinges fit with plenty of cabinet doors, supporting and facilitating designers ideas. The hinge’s effortless opening, easy and smooth closing and long durability contribute to the enjoyment for furniture users.
- Mature product range, widely used.



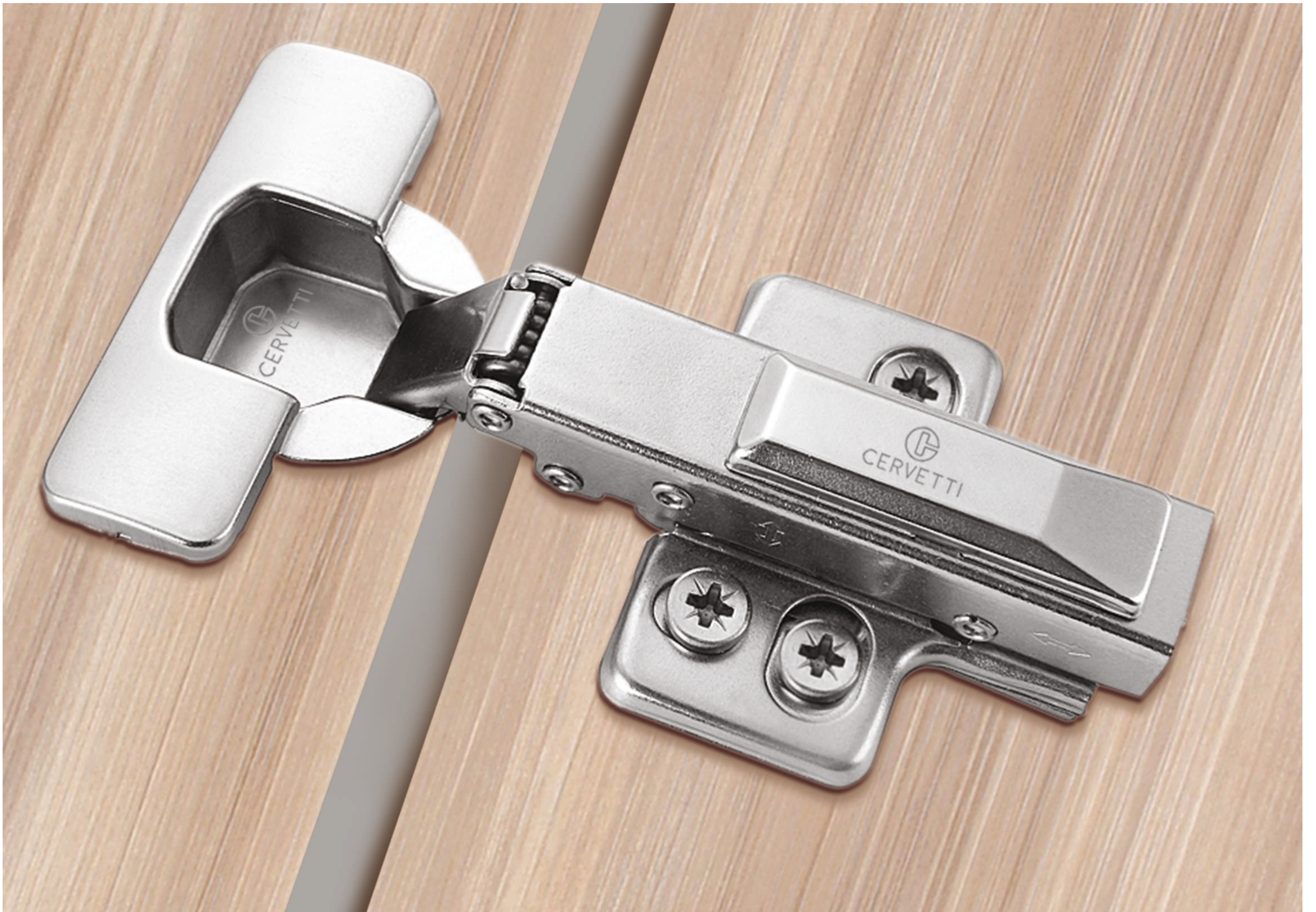



# HINGES

Slide-on Two-way Hinges

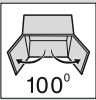

## PRODUCT



## APPLICATION

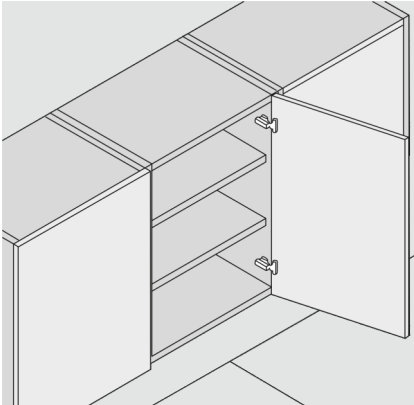

## DESCRIPTION

- 0, 8, 16 crank sizes
- Slide-On Two-way hinges
- Material: Ni plated iron
- Angle of opening: 100°
- Panel Board size: 3-7 mm
- Thickness of board: 14-28mm
- Hinge-cup perforate diameter: 35mm | Deep 11.8 mm | Hole Pitch 48mm or 52mm

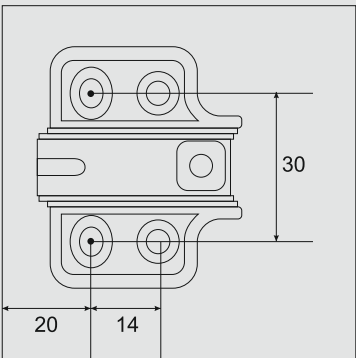
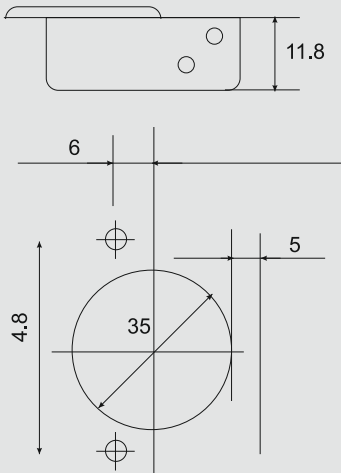

### 0 - full overlay



Item No. **CLH-RG-077**

### 8 - half overlay



Item No. **CLH-RG-088**

### 16 - inset



Item No. **CLH-RG-099**

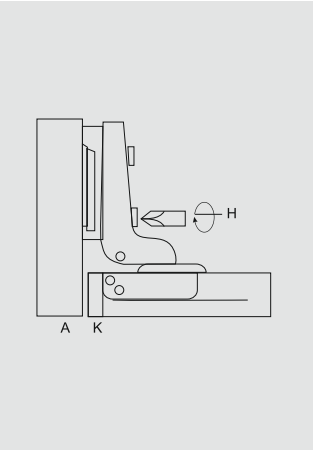
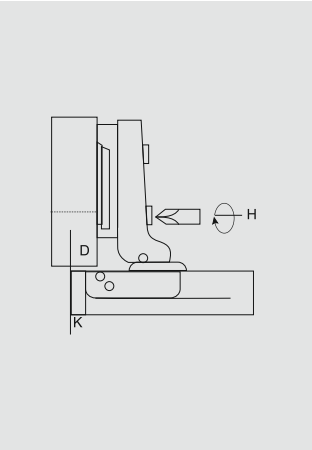
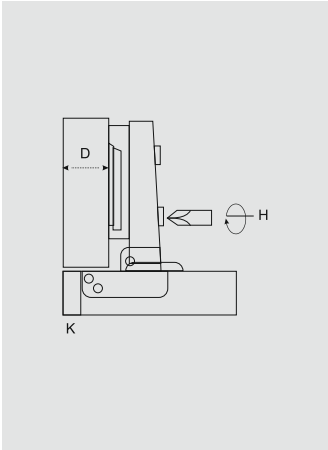

## HINGES

### 135 Deg 3D Clip-On Corner Hinges

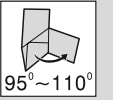

#### ORDER INFORMATION



#### DESCRIPTION

- 135° Degrees
- 3D clip on Hinges
- Finish: Nickel plated
- 3 dimensional post-installation adjustment

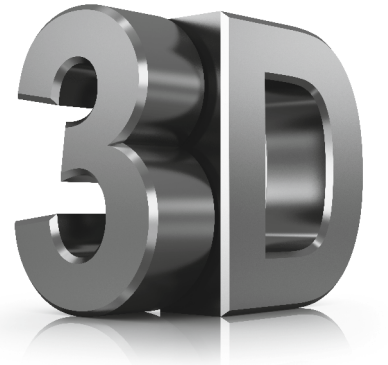

#### Φ 35mm Hinge cup types

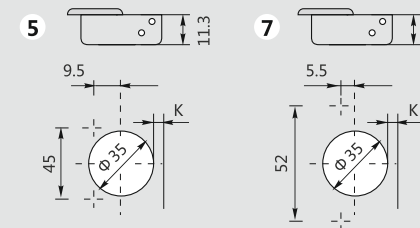

The solution of assembly problems where doors are mounted at a positive or negative angle requires the verification of drilling distances by a practical trial. Please do not hesitate to consult our technical support department for assistance.

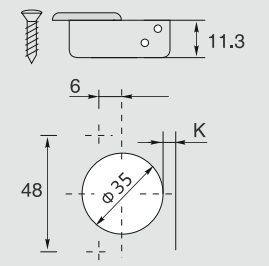

Nickel plated

#### Snap-on angled hinge(two way, cam-adjustable)

135°



Full Overlay 15°



Small Overlay 20°



Item No.

CLH-RG-135

Item No.

CLH-RG-135-15

Item No.

CLH-RG-135-20

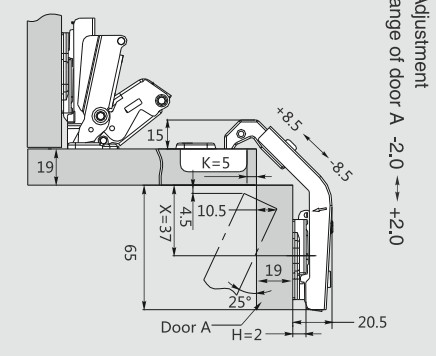

Adjustment range of door A -3.0 → +2.0

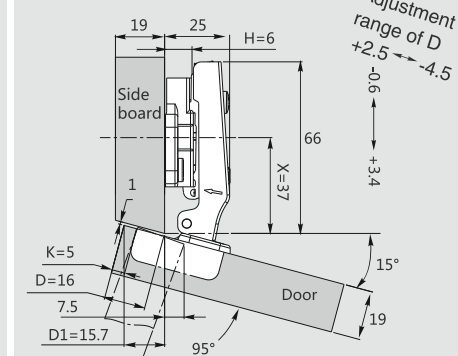

Adjustment range of D1 -2.0 → +2.0

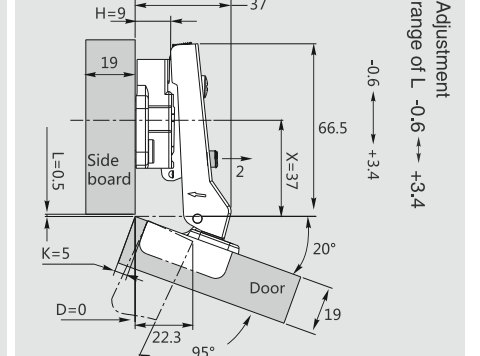

Adjustment range of D +5.0 → -1.0

# HINGES

Clip-On 2D & 3D Softclose Hinges



THE  
CER  
VET  
TI  
INDIA

### DESCRIPTION

- Opening angle: 110°
- Depth of hinge cup: 11.5mm
- Diameter of hinge cup: 35mm
- Range of door thickness: 16-26mm
- Possible drilling distances on the door (K): 3-6mm



### DESCRIPTION

- Opening angle: 110°
- Depth of hinge cup: 11.5mm
- Diameter of hinge cup: 35mm
- Range of door thickness: 16-26mm
- Possible drilling distances on the door(K): 3-6mm
- 3 dimensional post-installation adjustment

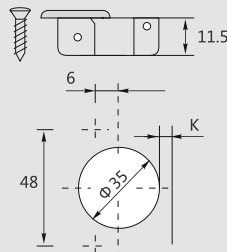

Nickel plated

### Φ 35mm Hinge cup types

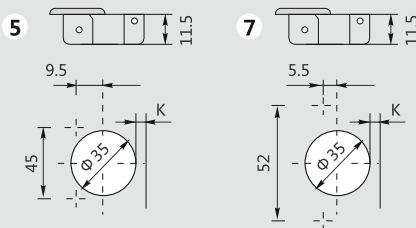

Use these formulas to determine the type of hinge arm, the drilling distance "K" and the height of the mounting plate "H" for each door application.

### Clip-On 2D Softclose Hinges

0 - full overlay

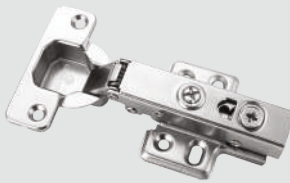

Item No. CLH-SC-011

C=0 Application with full overlay door  
D=19mm

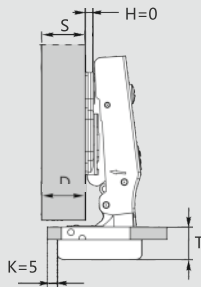

8 - half overlay

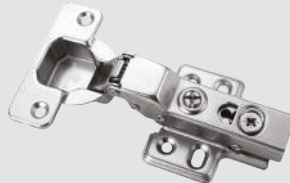

Item No. CLH-SC-022

C=9 Application with half overlay door  
D=10mm

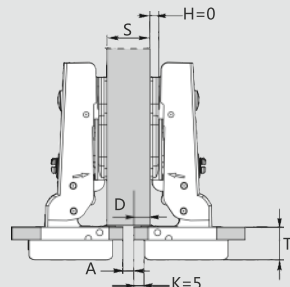

16 - inset

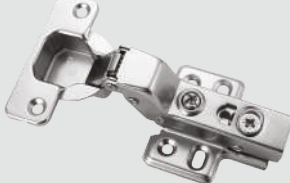

Item No. CLH-SC-033

C=18 Application with inset door  
A=1mm

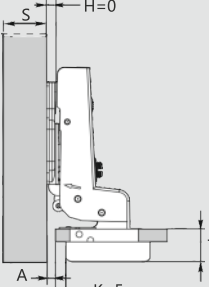

### Clip-On 3D Softclose Hinges

0 - full overlay

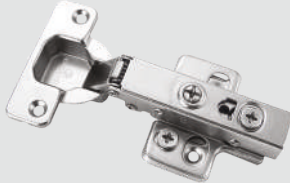

Item No. CLH-SC-044

C=0 Application with full overlay door  
D=19mm

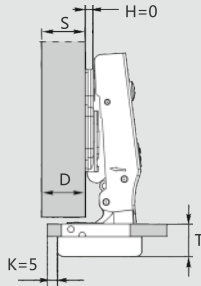

8 - half overlay



Item No. CLH-SC-055

C=9 Application with half overlay door  
D=10mm

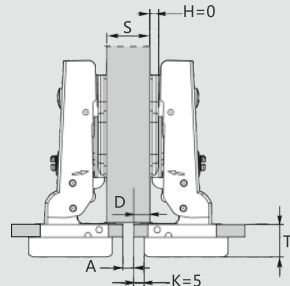

16 - inset

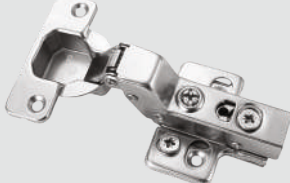

Item No. CLH-SC-066

C=18 Application with inset door  
A=1mm

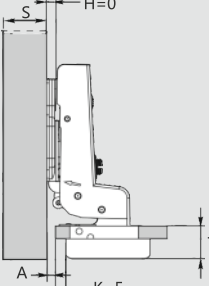

HINGES

155 Deg 3D Clip-On Softclose Hinges

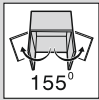

ORDER INFORMATION



APPLICATION

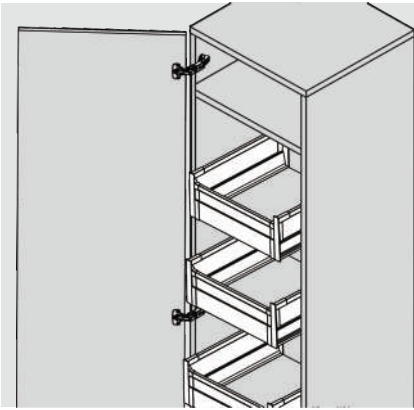

PLANNING

Φ 35mm Hinge cup types

5

7

Use these formulas to determine the type of hinge arm, the drilling distance "K" and the height of the mounting plate "H" for each door application.

Nickel plated

DESCRIPTION

- Opening angle: 155°
- Depth of hinge cup: 11.5mm
- Diameter of hinge cup: 35mm
- Range of door thickness: 16-24mm
- Possible drilling distances on the door(K) 3-6 mm
- 3D clip on softclose hinges
- 3 dimensional post installation adjustment



Application

The door combined with a mounting plate H=0, opens at 90° with a 2.3mm protrusion allowing objects(e.g.drawers) move from inside of the cabinet.

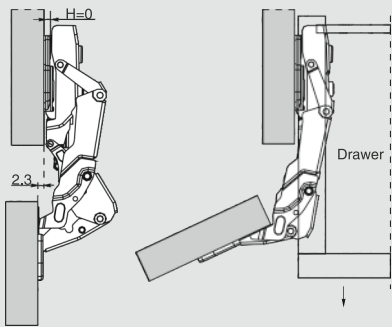

Full overlay C=0

No gap is required when door thickness is less than 24mm. A trial assembly is recommended when door thickness is more than 24mm.

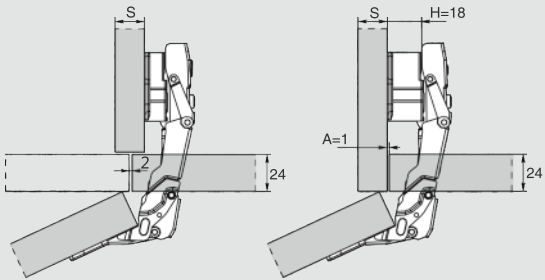

Half overlay C=9

Inset C=18

Snap-on soft close hinge 155° (two way, cam-adjustable)

Full overlay C=0	Half overlay C=8	Inset C=16
Item No. (Soft close) <b>CLH-SC-155</b>	Item No. (Soft close) <b>CLH-SC-155-8</b>	Item No. (Soft close) <b>CLH-SC-155-16</b>
H=13+K (D)	H=13+K (D)	H=14+K (D)
H=0 Mounting plate only	H=9 Mounting plate only	H=18 Mounting plate only

Space needed to open the door

	T=	16	17	18	19	20	21	22	23	24
K=3	A=	0	0	0	0	0	0	0	0	0
K=4	A=	0	0	0	0	0	0	0	0	0
K=5	A=	0	0	0	0	0	0	0	0	0
K=6	A=	0	0	0	0	0	0	0	0	0





ORDER INFORMATION

Application with full overlay door

S = Thickness of the cabinet side

A = Reveal

D = Required door overlay

L = Gap between door and carcass

T = Door thickness

H = Height of the mounting plate

K = Drilling distance

G = Hinge constant

Whatever door overlay is required, you can select from our range the combination of both the type of hinge arm and the thickness of mounting plate necessary to solve your construction problem and avoid the need to stock too many different components.

Application with half overlay door

S = Thickness of the cabinet side

A = Reveal

D = Required door overlay

L = Gap between door and carcass

T = Door thickness

H = Height of the mounting plate

K = Drilling distance

G = Hinge constant

Whatever door overlay is required, you can select from our range the combination of both the type of hinge arm and the thickness of mounting plate necessary to solve your construction problem and avoid the need to stock too many different components.

Application with inset door

S = Thickness of the cabinet side

L = Gap between internal face of door and internal cabinet elements(e.g.shelves, drawers,etc.)

T = Door thickness

H = Height of the mounting plate

K = Drilling distance

A = Reveal

G = Hinge constant

Whatever door overlay is required, you can select from our range the combination of both the type of hinge arm and the thickness of mounting plate necessary to solve your construction problem and avoid the need to stock too many different components.

PLANNING

Simulation of the opening movement of a 110° hinge with full overlay door

Simulation of the opening movement of a 110° hinge with half overlay door